

# Universal instructions for removal and installation of filler / dipstick inserts

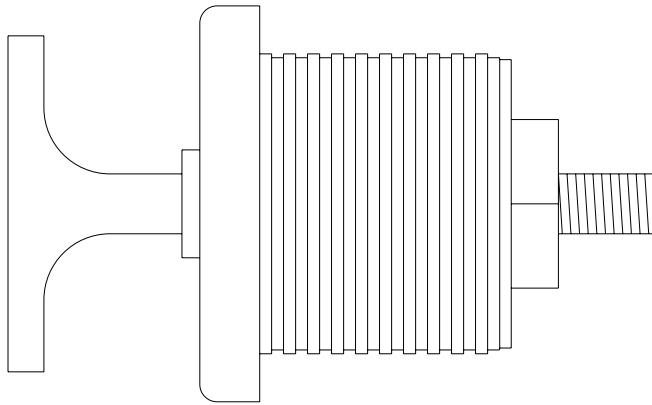

1131 VIA CALLEJON, SAN CLEMENTE, CA 92673

© 2007 Energy Suspension. All rights reserved.  
May not be reproduced, in any form, or by any means,  
without the written consent of Energy Suspension.



1. TIGHTEN NUT ENOUGH TO EXPOSE GOOD THREAD'S.
2. GRIND OR USE THREADING DIE OF PROPER SIZE TO REMOVE DEFORMED THREAD'S.
3. REMOVE NUT
4. REPLACE PART
5. INSTALL NUT
6. DEFORM END OF TREAD'S TO PREVENT NUT FROM COMING OFF.

17121

SMAR07 BRH

INSTRUCTION SHEET 17121

# Universal instructions for removal and installation of filler / dipstick inserts



1131 VIA CALLEJON, SAN CLEMENTE, CA 92673

© 2007 Energy Suspension. All rights reserved.  
May not be reproduced, in any form, or by any means,  
without the written consent of Energy Suspension.

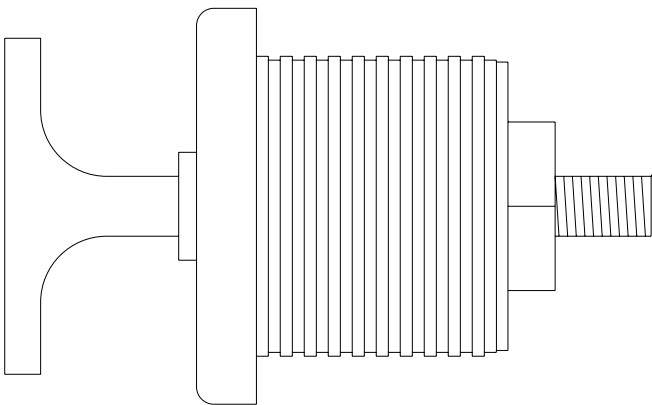

1. TIGHTEN NUT ENOUGH TO EXPOSE GOOD THREAD'S.
2. GRIND OR USE THREADING DIE OF PROPER SIZE TO REMOVE DEFORMED THREAD'S.
3. REMOVE NUT
4. REPLACE PART
5. INSTALL NUT
6. DEFORM END OF TREAD'S TO PREVENT NUT FROM COMING OFF.

17121

SMAR07 BRH

INSTRUCTION SHEET 17121